



SECTION 13

HUME DOORS

HUME DOORS

Alfresco Multifold

BFR405 Entry Door

BAL40 Weatherguard Entry Frame

BFR Entrance Range

Elite Entrance Range

Frontier Barn Doors

Hampton Collection

Evolution Cavity



ALFRESCO MULTIFOLD

DOUBLE YOUR LIVING SPACE BY BRINGING THE OUTSIDE IN



- ✓ Relaxed Alfresco Living
- ✓ Factory Assembled
- ✓ Includes JST1 Clear Glazed Doors
- ✓ Complete Weather Sealed System

Double your living space by bringing the outside in! Compliment your home and enjoy the relaxing style of Alfresco living featuring the Hume Alfresco folding weather sealed door system.

Incorporating JST1 Clear Glazed Doors and available in 2, 3, 4, 5 or 6 door configurations to fit any space.



BAL40 SYSTEM

BUSHFIRE COMPLIANT TO BAL40

NEW

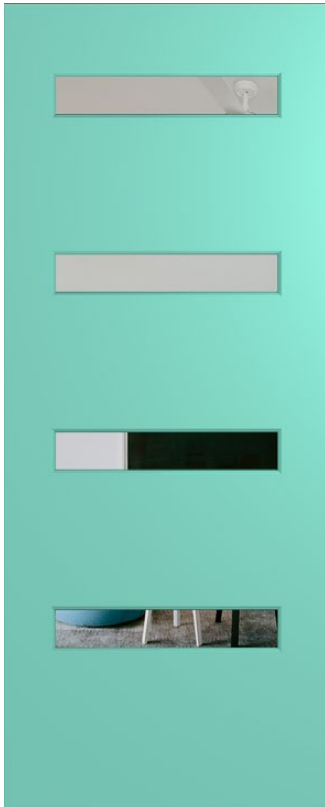

BFR405

BFR405 ENTRY DOOR

- The complete BAL40 timber door solution
- BAL40 tested and compliant to AS1530.8.1
- Maxi vermiculite fire core with 32mm meranti stiles, 32mm meranti bottom rail and 18mm hardwood top rail
- Tempered Hardboard faces
- Double sided fire resistant hardwood glazing bead
- 6mm Clear Toughened Glass
- Available in 45mm thick only
- Available in special sizes up to 2340x1200x45

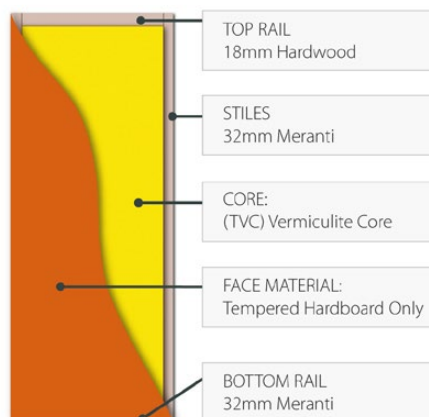

Bushfire zoned BAL40 door system. These systems have been tested and are BAL40 compliant when installed as per AS3959-2011.

Door and frame must be supplied together to comply to BAL40 as tested to AS1530.8.1

FACE OPTIONS



Tempered Hardboard (only)

GLASS OPTIONS



Clear (6mm)

BEADING

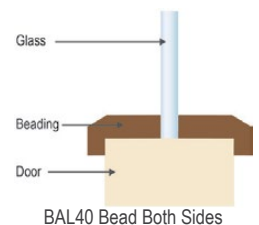

WEATHERGUARD SILL

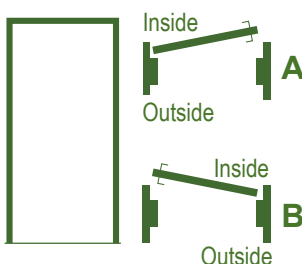

BAL40 WEATHERGUARD ENTRY FRAME

- The complete BAL40 timber door frame solution
- BAL40 tested and compliant to AS1530.8.1
- Hardwood Jambs and Head compliant to BAL40
- Frames have full intumescent fire & smoke perimeter seal - compliant to BAL40
- Seal is removable for painting frame and is easily reinstalled
- Non-combustible aluminium sill - improved heat control
- Generous tread pattern on sill - reduces slip
- Sill supplied with protective tape during construction - removable at handover



Watch the burn test

www.humedoors.com.au/bal40/BAL40-Burn-Test.mp4



BFR ENTRANCE RANGE

BUSHFIRE RESISTANT DOORS TO SUIT UP TO BAL29 ZONES



Bushfire zoned doors. These doors are tested and are BAL compliant when installed as per AS 3959-2009. Check the Hume Doors website for BAL information.

Doors suitable for bushfire zones BAL 12.5, 19, 29 when installed per AS 3959-2009- AMDT3-2011, solid construction with merbau glazing beads

FACE OPTIONS



SPM

Merbau



Tempered Hardboard (standard)

GLASS OPTIONS

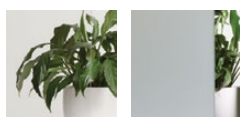

Clear (6mm)

Frost (6mm)



Africana (6mm)

Grey Tint (6mm)

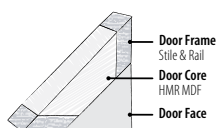

Standard Door Size:
2040x820x40

Routed: Both sides (BFR9 only)
Moulding: One side (BFR13 only)

Check with your Hume state office for made to order



BUSH FIRE RESISTANT

Hume offers an extensive range of doors designed and manufactured to meet the specific regulatory requirements of building in designated bushfire zones. We have a comprehensive range of doors that meet BAL12.5, BAL19 and BAL29 criteria as specified in AS3959. Select from either tempered hardboard or veneer finished solidcore doors with 6mm tempered safety glass.





ELITE ENTRANCE RANGE

ALUMINIUM DOORS TO WITHSTAND ALL WEATHER CONDITIONS



- ✓ Ideal for Exposed Areas
- ✓ Energy Efficient
- ✓ Low Maintenance
- ✓ Works with Hume Weatherguard Frame

The Elite Aluminium Range is sleek, durable and able to withstand all weather conditions.

Available in 5 different designs, 4 Standard Powder Coated Finishes and 2 Woodgrain Finishes which means there is a design and finish to suit any home.

Door handle comes complete with Mortice and C4 Euro.

A RANGE OF DESIGNS & FINISH OPTIONS AVAILABLE TO SUIT YOUR STYLE

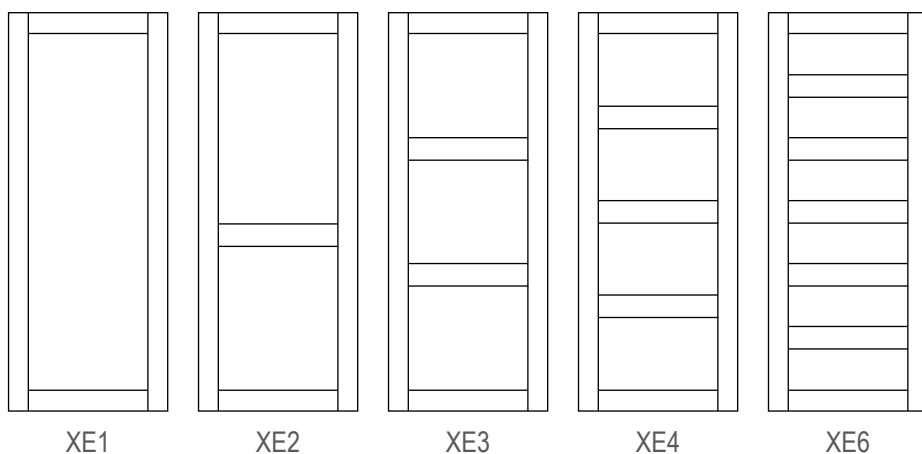

FINISH OPTIONS

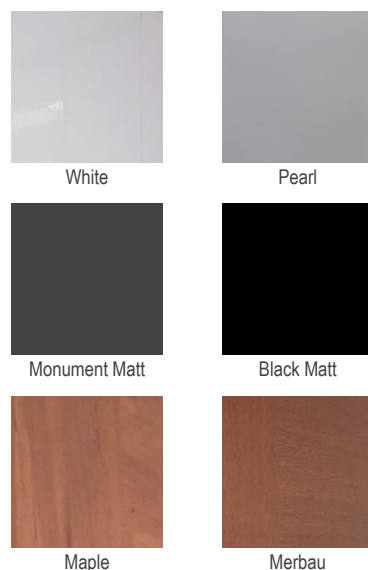

Maximum Door Size = 2340mm h x 1200mm w x 40mm
Doors available loose (door only), or complete with Hume Weatherguard Frame and door furniture.

STEEL DOOR FRAMES

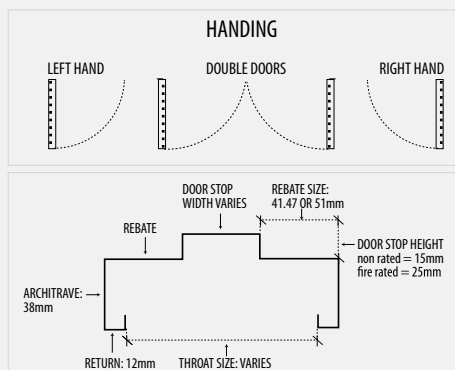
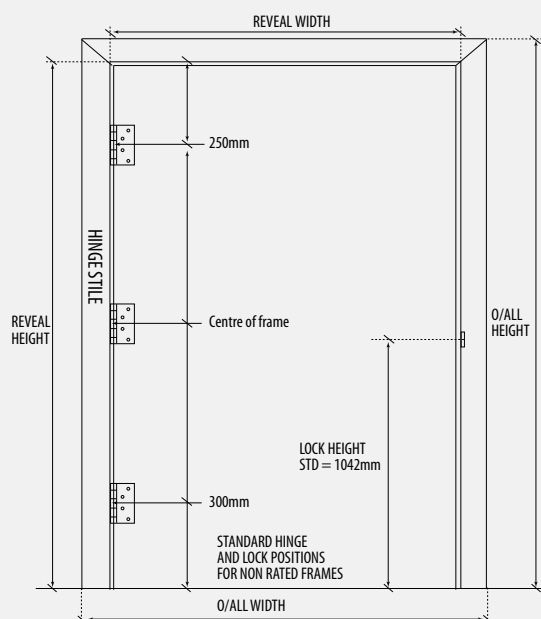

- 3 Hinges (required to meet door manufacturer's guarantee for solid doors)

- Hinges screw fixed to frame to allow removal if required for easy door hanging

- Simple installation

- Ready for priming or painting

- Zinc finish

All components supplied for brick/block and partition walls

Left or right hand available

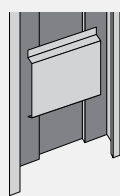

STRAP FIX

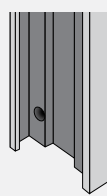

TUBE FIX

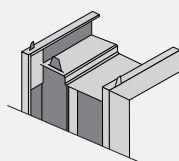

CORNER DETAIL

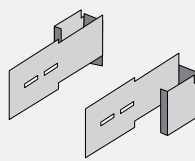

STUD CLIPS

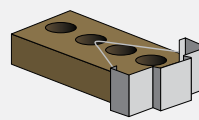

JAMB BRICK

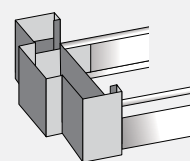

JAMB STEEL

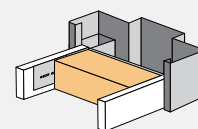

JAMB GYPROCK

DOOR PRODUCTS



OVERSIZE DOORS

At Hume Doors & Timber we manufacture doors for a multitude of applications and your State office will gladly accept your enquiry no matter how large or small.

As a guide, we provide the following:



AIR GRILLS

- Aluminium
- Snap in



ALUMINIUM T-BARS



METAL CLAD DOORS

- Zinc
- Colorbond

FIRE DOORS

1HR, 2HR, 3HR, 4HR

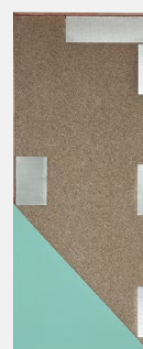

- Incorporate TVC Core
- Full metal inner plates for hinge locations, closer and lock
- Choice of face materials: MDF, ply, tempered hardboard



GLAZED PANELS

- Suit Firedoors
- Panel Sizes: 600x100, 300x200 or 450x120





FRONTIER BARN DOORS

THE PERFECT BALANCE OF STYLE & FUNCTIONALITY



- ✓ Easy to Install
- ✓ Perfect room divider
- ✓ Modern or traditional designs
- ✓ Create authentic barn door look

Barn doors are not just for barns, from the countryside these wide sliding doors have entered modern houses to become popular interior decor pieces.

From cosy hide away bedrooms to rustic home office doors and unique wardrobe solutions, the Frontier sliding system is the perfect product to conceal - and reveal - functional open spaces.

3 EXCITING RANGES TO DISCOVER



✓ STANDARD



✓ ULTIMATE



✓ RUSTIC



HAMPTON COLLECTION

INSPIRING INTERNAL DOORS FOR HAMPTON STYLE HOMES



A RANGE OF DESIGNS AND GLAZING OPTIONS AVAILABLE TO SUIT YOUR STYLE



HAM1
(INLAY)



HAM4
(FROST)

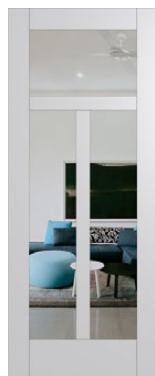

HAM5
(CLEAR)



HAM6
(INLAY)

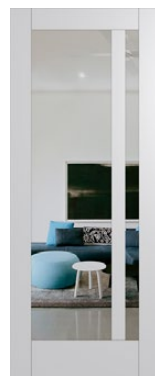

HAM10
(CLEAR)



HAM12
(FROST)

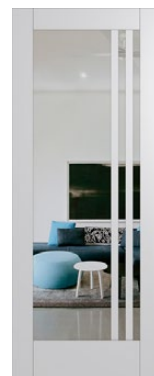

HAM16
(CLEAR)



EVOLUTION COMPLETE

EVOLUTION CAVITY INCORPORATING SOFT CLOSER & ONE TOUCH RELEASE



- ✓ Effortless Operation
- ✓ Soft Closing Technology
- ✓ One Touch to Release Door
- ✓ Holds Door Flush in Cavity

The Evolution Complete is the perfect flush cavity sliding door system. Hume Doors have designed the Evolution Complete to incorporate our One Touch Release and Soft Closing technology, allowing for the most effortless operation of any sliding door system.

The One Touch Release is magnetised and will hold your door firmly inside the cavity. With one easy touch the spring-loaded system will release the door, sliding with ease across the opening while the Soft Closer will gently slow and close the door.

